

# THORP INDUSTRIAL PARK CONCEPT PLAN

LOCATED IN THE SW 1/4 OF THE SW 1/4, THE SE 1/4 OF THE SW 1/4, SECTION 25, T. 29 N., R. 04 W., CITY OF THORP, CLARK COUNTY, WISCONSIN

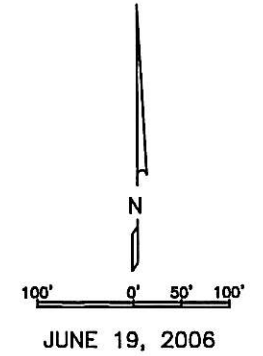

UNPLATTED LANDS OWNED BY THE CITY OF THORP. NO SURVEY OR LEGAL DESCRIPTION AVAILABLE FOR THESE LOTS AT THIS TIME.



SW CORNER SECTION 25

